

MATCHLINE JOINS SHEET 3

**PLANT SCHEDULE:
KITCHEN GARDEN**

KEY	BOTANIC NAME	QTY.
A.v.	ALOE VERA	45
B.o.	BORAGO OFFICINALIS	70
B.ol.	BRASSICA OLERAEA	130
C.a.	CAPSICUM ANNUUM	14
C.l.	CITRUS LIMON	3
C.s.	CYNARA SCOLYMUS	5
F.c.	FICUS CARICA	4
L.n.	LAURUS NOBILIS	3
L.a.	LAVANDULA ANGUSTIFOLIA	44
L.d.	LAVANDULA DENTATA	70
O.e.	OLEA EUROPAEA	8
O.v.	ORIGANUM VULGARE	380
R.o.	ROSMARINUS OFFICINALIS	50
S.o.	SALVIA OFFICINALIS	70
T.v.	THYMUS VULGARIS	130

**PLANT SCHEDULE:
MAY GIBBS GARDEN**

KEY	BOTANIC NAME	QTY.
A.i.	ACACIA IMPLEXA	5
A.h.	ACTINOTIS HELIANTHI	368
B.s.	BANKSIA SERRATA	7
B.m.	BORONIA MEGASTIGMA	103
C.f.	CORYMBIA FICIFOLIA	5

PICNIC / OPEN AREA

MIXED GARDEN BEDS
REFER TO SHEET 9 FOR PLANT SCHEDULE

**PLANT SCHEDULE:
PICNIC / OPEN GARDEN**

KEY	BOTANIC NAME	QTY.
E.m.	EUCALYPTUS MELLIODORA	10
E.s.	EUCALYPTUS SCOPARIA	18
L.c.S.	LOMANDRA CONFERTIFOLIA 'SEASCAPE'	1200
L.I.T.	LOMANDRA LONGIFOLIA 'TANIKA'	2400
M.p.	MYOPORUM PARVIFOLIUM	200

MATCHLINE JOINS SHEET 10

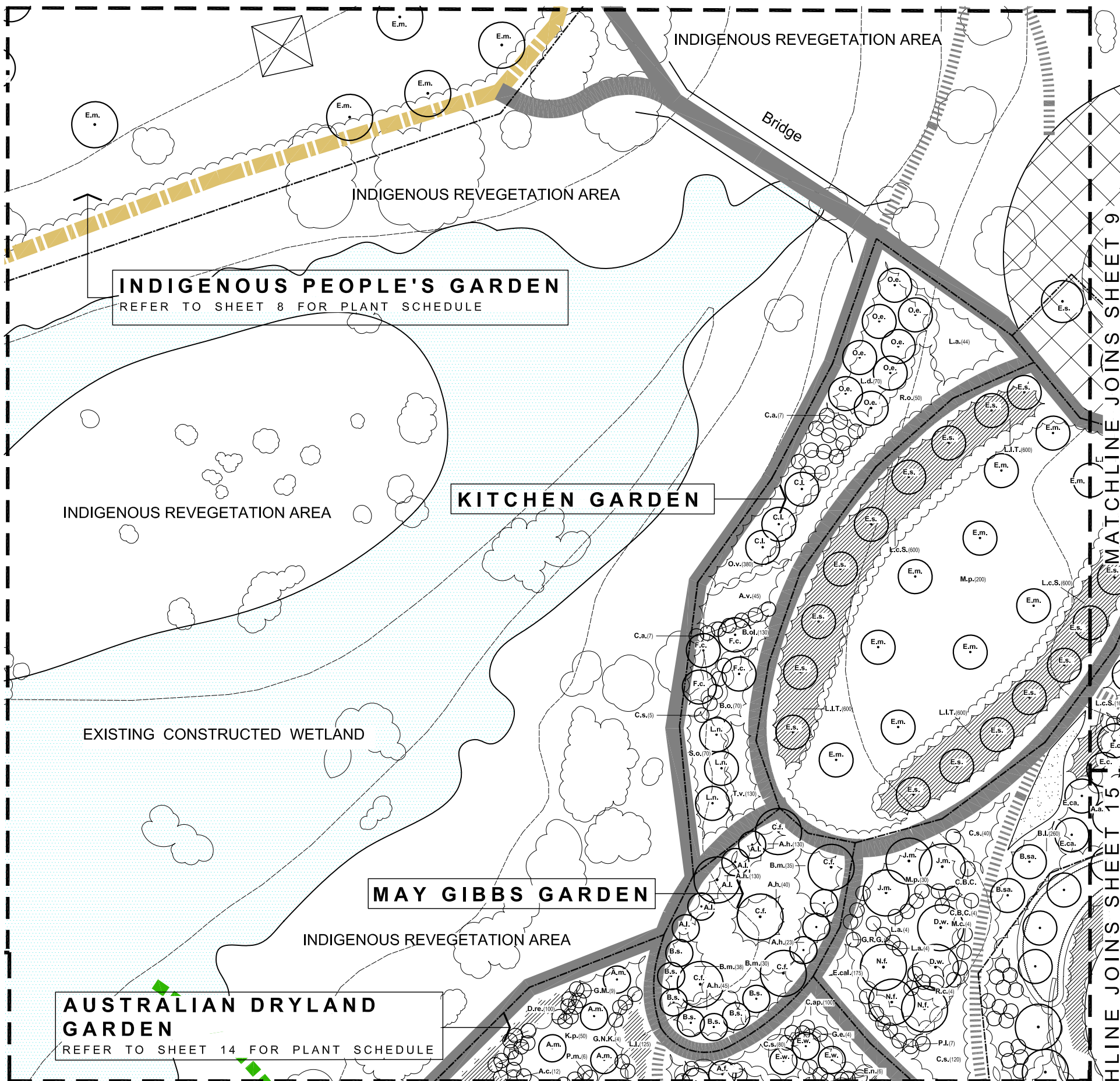

MATCHLINE JOINS SHEET 9
MATCHLINE JOINS SHEET 15

MATCHLINE JOINS SHEET 14

FRAMEWORK PLANTING PLAN (SHEET 11 OF 15)

MELTON BOTANIC GARDEN
SHIRE OF MELTON

PRINT ISSUE: R. Thomas 18-02-09
Report 15-04-09

REVISIONS: REV A - 14-04-09

Drawn: M. B.

Date: 13-02-09

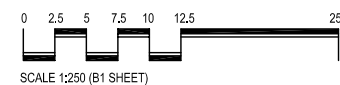

Michael Smith and Associates
Landscape Architecture and Urban Design
Office: 1st Floor, 407 Whitehorse Road, Balwyn, 3103
Postal: 5 Jervis Street, Camberwell, 3124
Tel: 9830 0414 Fax: 9830 2555

In association with:
Brecknock Consulting Pty Ltd
Practical Ecology Pty Ltd
Traffix Group Pty Ltd
Paoli Smith Pty Ltd